

IG 17- F with RNC Feedback

Motor Drawing

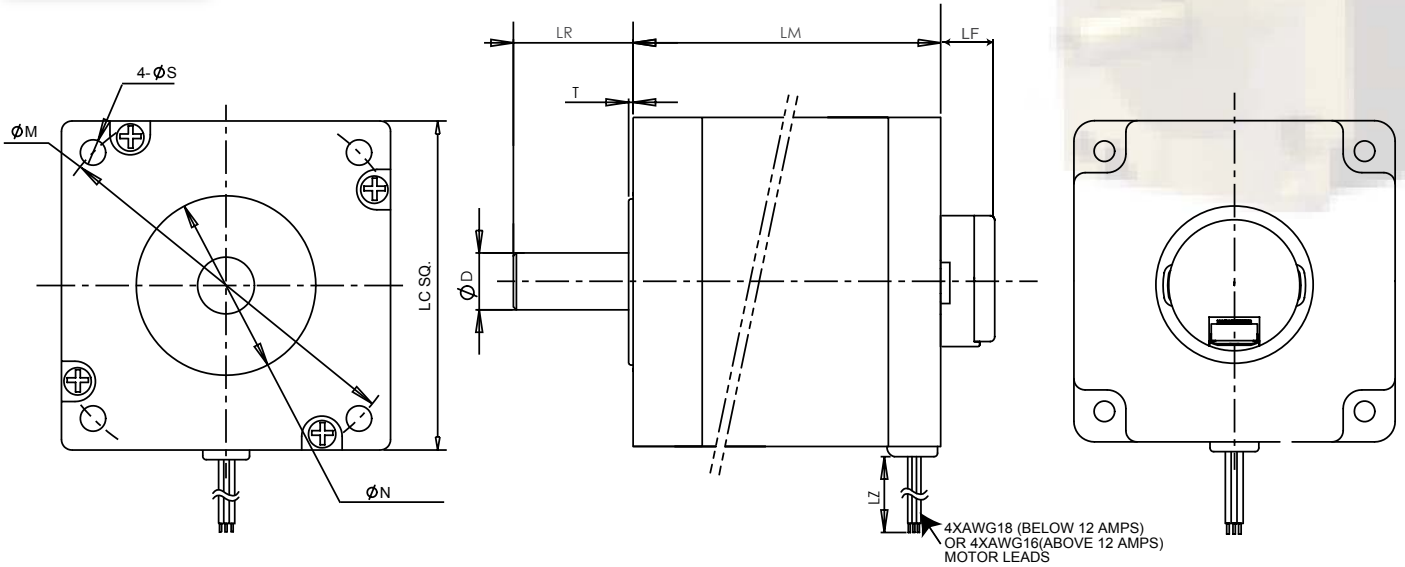

FRONT SHAFT OPTIONS

- (1) SMOOTH SHAFT: AS SHOWN IN THE VIEWS.
- (2) KEYWAY SHAFT

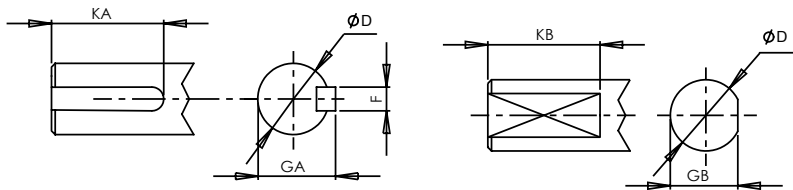

NOTE:
THE MOTOR HAS IP40 ENCLOSURE
AND SHAFT PROTECTION.

Units: Inches (mm)

IG	LM	LF	T	LR	LC	LH	LZ	N	S	M	
17	A	1.496 (38)	0.55 (14.0)	0.079 (2.0)	0.945 (24)	1.665 (42.3)	1.665 (42.3)	12 (304.8)	0.866 ⁰ _{-0.002} (22.00 ⁰ _{-0.05})	0.118 (3.0)	1.725 (43.815)
	B	2.126 (54)									
	C	2.756 (70)									

For IG17, dimension S is M3*0.5 min depth 0.2 (5.1) threaded hole

Imperial Shaft Option (S/F/K), Units: inches						Metric Shaft Option (X/Y/Z), Units: mm						
IG	D	F	GA	KA	GB	KB	D	F	GA	KA	GB	KB
17	0.1969 ⁰ _{-0.0005}	-	-	-	0.177 ⁰ _{-0.004}	0.50	5 ⁰ _{-0.013}	-	-	-	4.5 ⁰ _{-0.1}	12.7

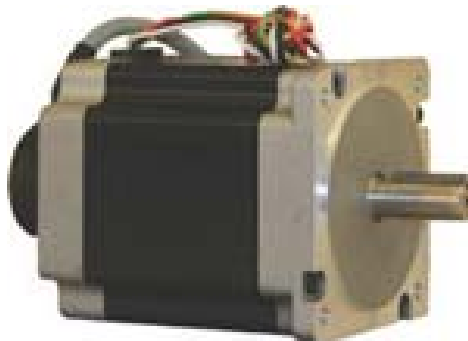

Feb, 21, 06

IG 17- F with RNC Feedback

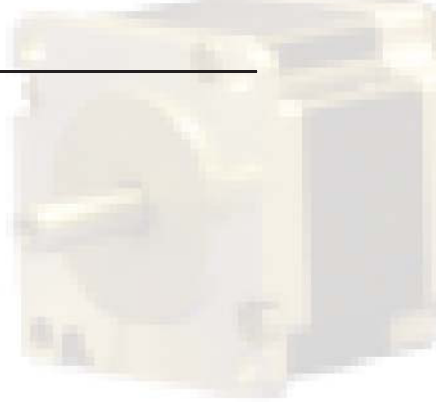

Power Cable Wire Code

Wire Color	Function
YEL	PHASE U
GRN	PHASE V
BLU	PHASE W
GRN/YEL	PE

Renco Encoder

Renco Encoder Data

Parameter	Values
Input Voltage	5 VDC \pm 10% Single Supply
Input Current Requirement	175 mA
Output Data	Line driver
Output Format	Square wave two channel quadrature with index & commutation signals
Frequency Response	500 kHz
Minimum Edge Separation	45° electrical angle
Commutation Format	Three commutation channels, 4 cycles/360° electrical angle for eight poles
Termination	15 pins JAE P/N F1_W15P_HF interface
Operating Temperature	-30°C to 115°C
Storage Temperature	-40°C to 125°C
Available line counts	250, 256, 500, 512, 1000, 1024, 2000, 2048, 4000, 4096, 8000, 8192 ppr

Encoder Wiring Diagram

Pin #	Function	* Color
1	CH A	BRN with BLK
2	CH A-	BLK with BRN
3	CH B	BLU with BLK
4	CH B-	BLK with BLU
5	INDEX	ORN with BLK
6	INDEX-	BLK with ORN
7	CH U	YEL with BLK
8	CH U-	BLK with YEL
9	CH V	GRN with BLK
10	CH V-	BLK with GRN
11	CH W	RED with BLK
12	CH W-	BLK with RED
13	+5VDC	WHT with BLK
14	GND	BLK with WHT
15	SHIELD	SHIELD

* Optional:

Connector with shielded 3M cable per customer specified length

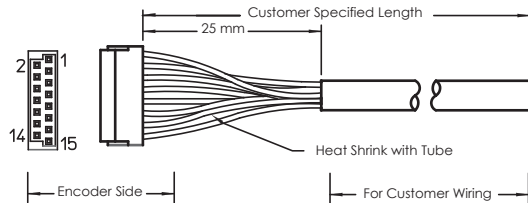

Mating Connector: JAE P/N F1-W15P-HF

Encoder Output Waveforms

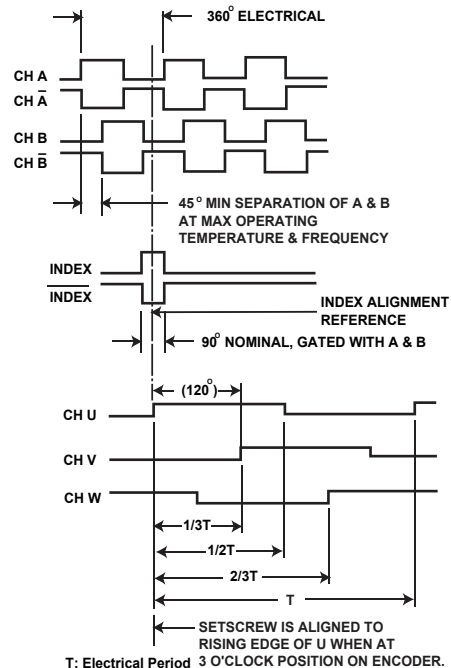

T: Electrical Period 3 O'CLOCK POSITION ON ENCODER.

Sep, 26. 07